

Maria Hoehly Anna Hoehly

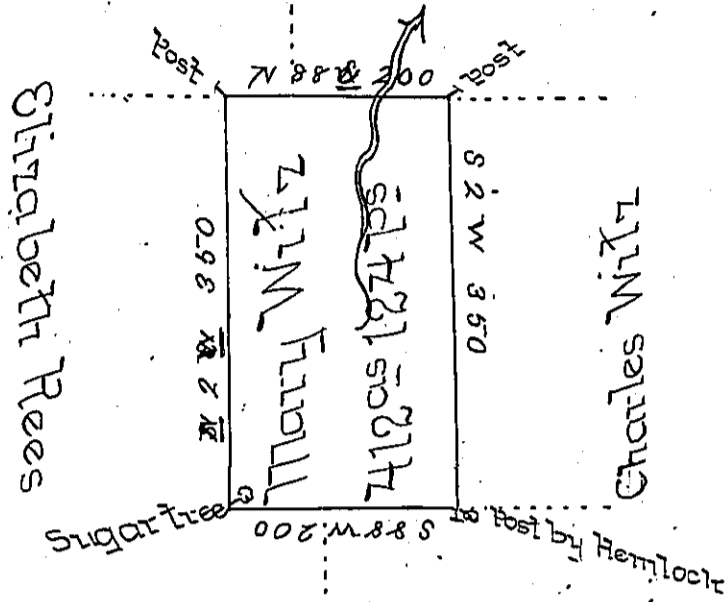

P. Roadarmal Jacob Witz

By Virtue of a Warrant dated 17th August 1793 Surveyed
 6 September 1793 to Mary Witz the above tract of Land Sit-
 uate on the Waters of Wappapinny Creek in Luzerne Cou-
 nty Containing four Hundred and Twelve Acres and one
 hundred & twenty four perches & the allowance of Six Per
 Cent for Roads &c^a -

Anty. Crothers D.S.

To Daniel Broadhead Esquire
 Surveyor General

IN TESTIMONY that the above is a copy of the original remaining on file in
 the Department of Internal Affairs of Pennsylvania, made
 conformably to an Act of Assembly approved the 16th day of
 February, 1833, I have hereunto set my Hand and caused
 the Seal of said Department to be affixed at Harrisburg,
 this seventh day of February 1899.

James W. Latta
 Secretary of Internal Affairs.